

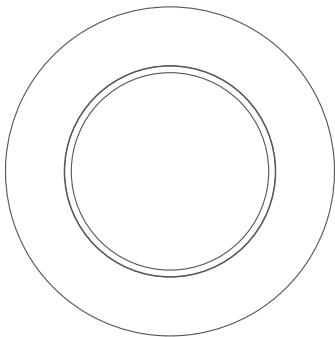

— Panic Button —



Quick Start Guide

Appearance

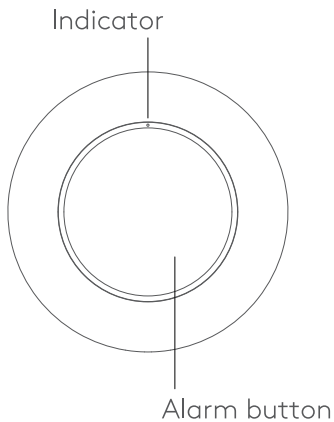

Packaging List

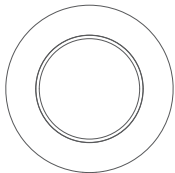

Panic Button x1



3M adhesive
strip x1



QSG x1

Download App :

- 1 Open your smartphone camera.
- 2 Scan the QR code below.
- 3 Tap the link that appears.
- 4 Download and install the Ximple W2 Plus app.



Ximple W2 Plus



Add Panic Button

- 1 Click Home Security Hub , then click "+" and select "Add peripheral" .

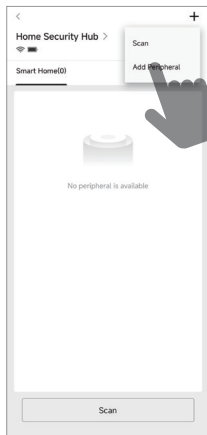

Add Panic Button

- 2 Pull out the insulation strip to power up the device , the green indicator will flash and the device will show in the App.

** Note: If the device does not show in the App and green indicator is off , please press and hold the alarm button for 10s to try again.*

- 3 Assign a room and click the "**Done**" to finish adding.

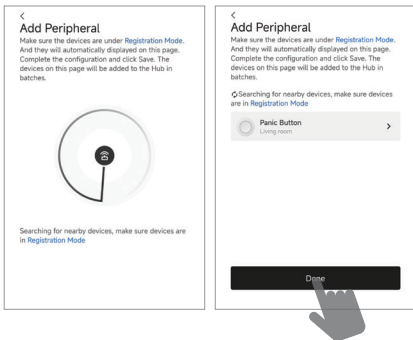

Device specifications

Feature	
Advanced Features	Signal Strength detection, Find me
Wireless Transmission	
Transmission Frequency	921MHz
Transmission Range (Open Space)	1000m
Advanced Tech	AES-128 Encryption FHSS TDMA
Electrical Characteristics	
Standard Battery Life	CR2032 x 1, Up to 2 years (standby mode)
General	
Operation Temperature	-10 °C to 55 °C (14 °F to 131 °F)
Dimension(WxHxD)	Φ50mm x 16mm
Weight	19.8g
Application Scenario	Indoor

Powered by ***bluguard***[®]

 www.bluguard.com.my